

# Industrial Sensor Node [ISN] Installation Instructions

Follow these steps to properly mount and connect your device. The instructions cover battery installation, alignment for optimal accuracy, and how to connect external sensors using the specified connectors. Ensure each step is completed for correct installation and reliable performance.

## Mounting

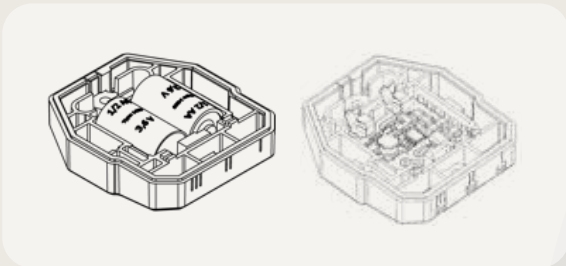

1. Battery-powered version you place the batteries in the cover according to the polarization direction shown in the picture. Skip this step if you are using an external power supply, as shown in the example to the right.



2. Fit the cover and tighten the screws.

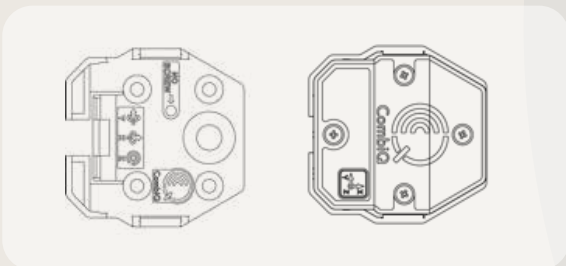

3. For best accuracy, mount the unit aligning the X, Y, and Z axes with those of the machine.

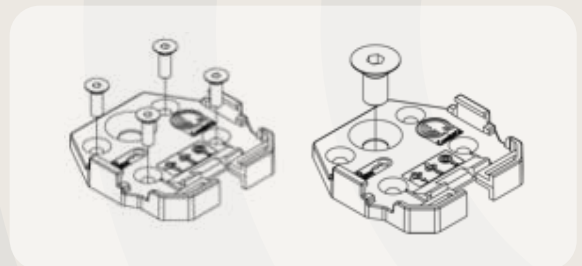

4. Install the mounting plate with the four M4 screws or one M8 screw as shown.

## Connection of External Sensors



1. Use the appropriate 5-pin connector with M8 thread.  
2. Push the plug fully into the port.  
3. Tighten the connector screw closure.



4. Refer to page 4 of the product datasheet for details of port and pin configurations.